

### GENERAL



Shure Model 512 combines an efficient “open-air” headphone with a close-talking dynamic microphone. The unit is unobtrusive, durable, comfortable, and provides a wide frequency range.

The 512 was designed for sports and news announcing, intercommunications systems, and special events remote broadcasting. It offers convenient hands-free operation, and a lightweight frame to reduce user fatigue. The unidirectional pickup pattern reduces unwanted background noise, permitting its use in noisy environments. The microphone characteristics are tightly controlled resulting in consistent response and output, and the headphone response is tailored to enhance voice intelligibility.

The headband easily adjusts to fit a variety of head sizes and hair-styles, and the microphone boom can be adjusted to accurately place the microphone cartridge at the corner of the user’s mouth. The microphone is supplied with a foam windscreen to reduce explosive “popping” sounds, and a cable clip to secure the cable to clothing.

### SPECIFICATIONS

#### MICROPHONE

##### Type

Dynamic, close-talking

##### Frequency Response (at 8 mm 5/16 in.)

50 to 15,000 Hz

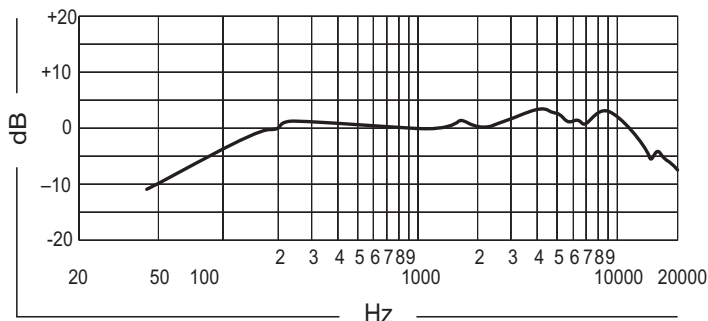

#### Polar Pattern

Cardioid (unidirectional) response - uniform with frequency, symmetrical about axis.

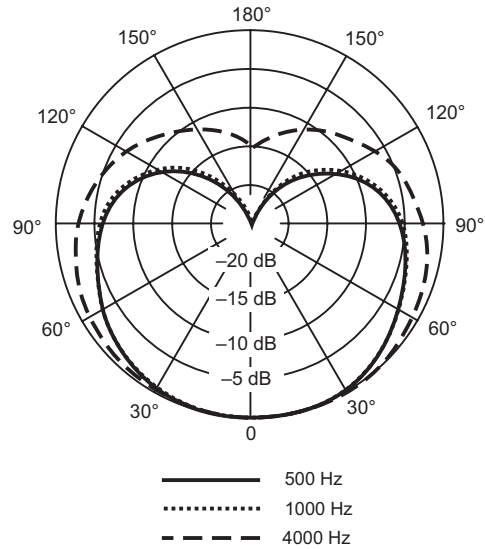

#### Impedance

Microphone rating impedance is 150 Ohms (200 Ohms actual) for connection to microphone inputs rated at 19 to 300 Ohms.

#### Output Level (closed-talked at 1,000 Hz)

Open-circuit voltage -47.0 dB (4.5 mV)

0 dB=1 volt per 100 microbars

Power Level -66.0 dB

0 dB=1 milliwatt per 10 microbars

#### Hum Sensitivity (typical)

38.4 dB equivalent SPL in 1 millioersted field

#### Polarity

Positive pressure on diaphragm produces positive voltage on red lead and pin 2 of connector.

#### HEADPHONE

##### Type

Dynamic, open-air, left side only

##### Frequency Response

100 to 10,000 Hz, tailored for voice intelligibility.

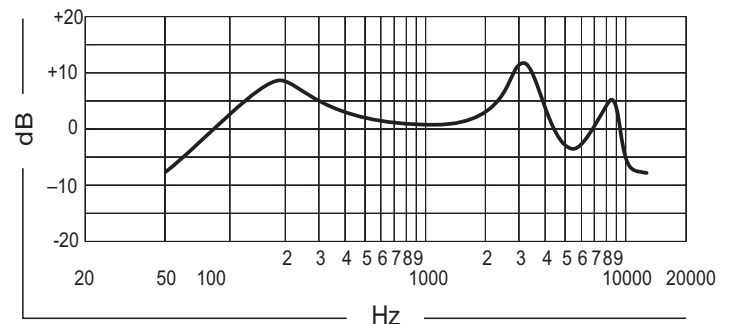

#### Impedance

300 Ohms at 1,000 Hz

**Polarity**

Positive voltage on cable conductor produces positive pressure.

**Output Level (at 1,000 Hz)**

94 dB SPL at ear with 1 mW input

**Internal Connections**

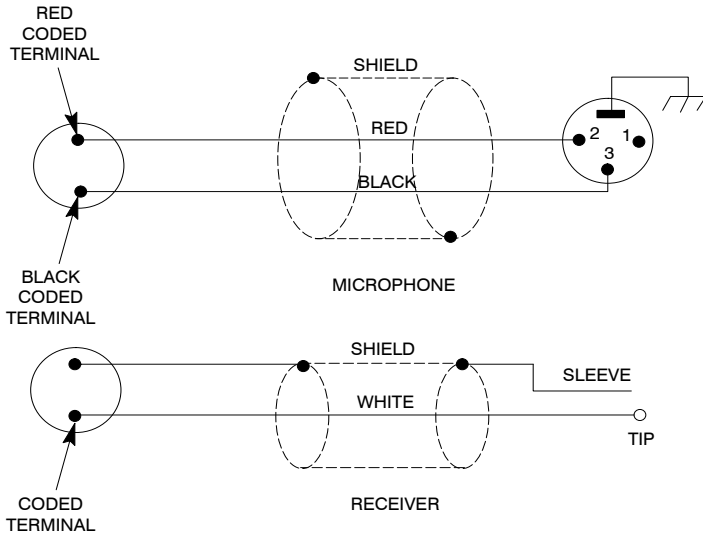

**USING THE MICROPHONE**

Snap the microphone boom into the rotating holder below the left earpiece. Put on the headset and adjust the earpads to the most comfortable position. The headset is designed for use with the microphone mounted on the left side. Slide and twist the microphone boom and rotate its holder until the microphone is located as close as possible to the left corner of the mouth (not directly in front).

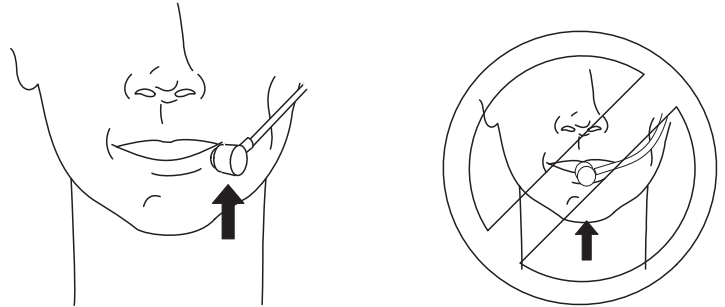

**REPLACEMENT PARTS**

Microphone Cartridge .....	R93
Headphone Cartridge .....	90FA2600
Pop Filter .....	90RX1371
Foam Earpad .....	49A78A

**MATERIAL**

**Cable**

2.1 m (7 ft.) attached cables: one 2-conductor shielded with black 3-pin XLR connector (microphone) and one single-conductor shielded with 2-circuit phone plug (headphones).

**Headset**

Stainless steel and thermoplastic with foam earpads.

**Dimensions**

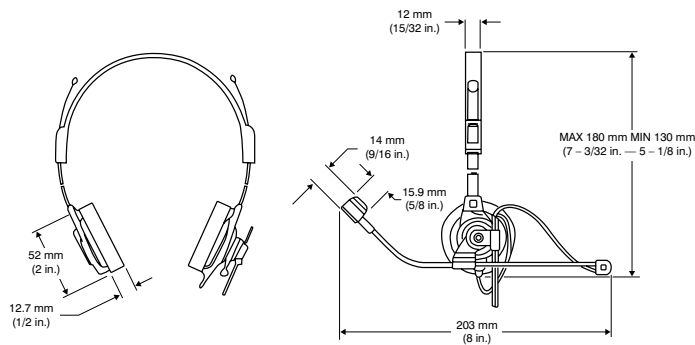

**Net Weight**

186 grams (6.5 oz.) including connectors



SHURE Incorporated <http://www.shure.com>  
 United States, Canada, Latin America, Caribbean:  
 5800 W. Touhy Avenue, Niles, IL 60714-4608, U.S.A.  
 Phone: 847-600-2000 U.S. Fax: 847-600-1212 Int'l Fax: 847-600-6446  
 Europe, Middle East, Africa:  
 Shure Europe GmbH, Phone: 49-7131-72140 Fax: 49-7131-721414  
 Asia, Pacific:  
 Shure Asia Limited, Phone: 852-2893-4290 Fax: 852-2893-4055